

DETAIL-2.0

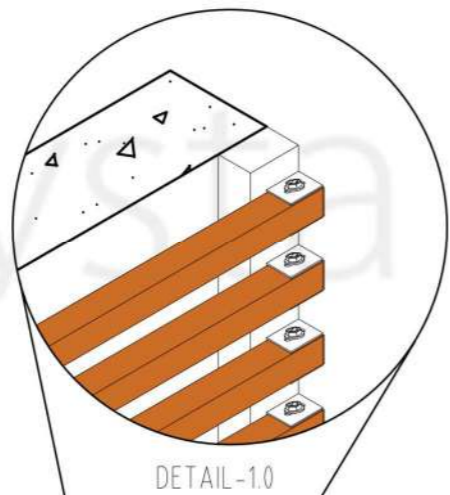

DETAIL-1.0

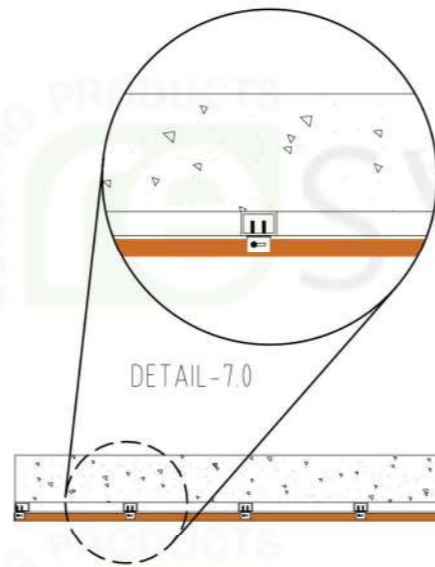

DETAIL-7.0

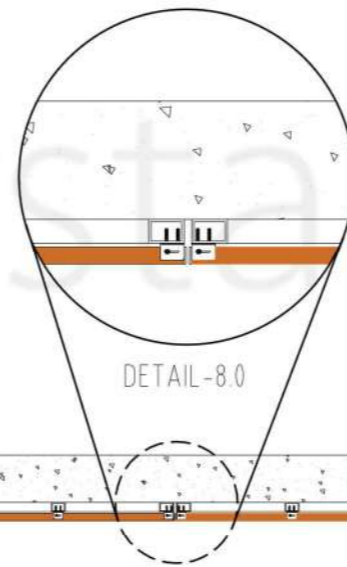

DETAIL-8.0

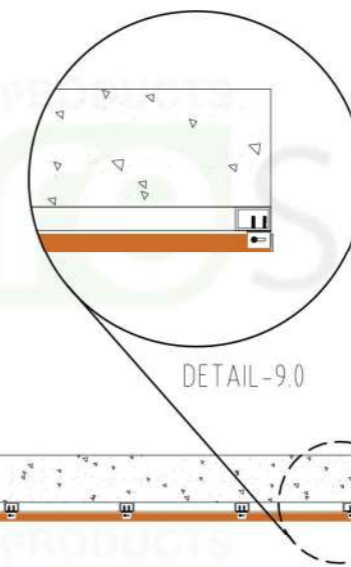

DETAIL-9.0

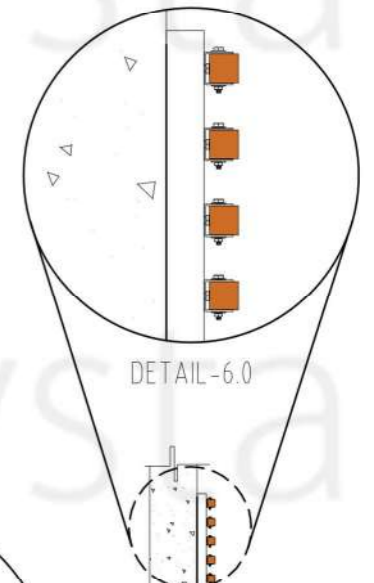

DETAIL-6.0

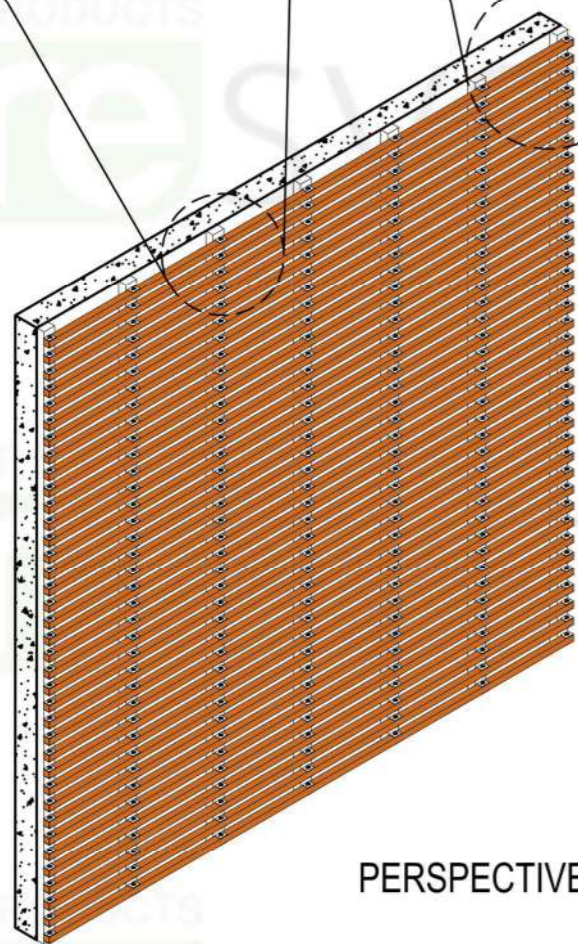

PERSPECTIVE

MULTI-BOARD TOP VIEW



TOP VIEW

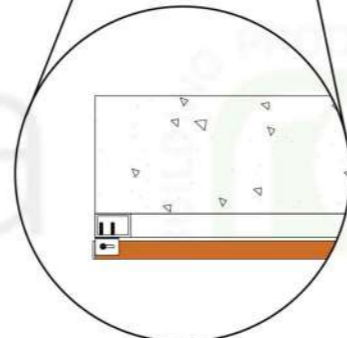

DETAIL-3.0

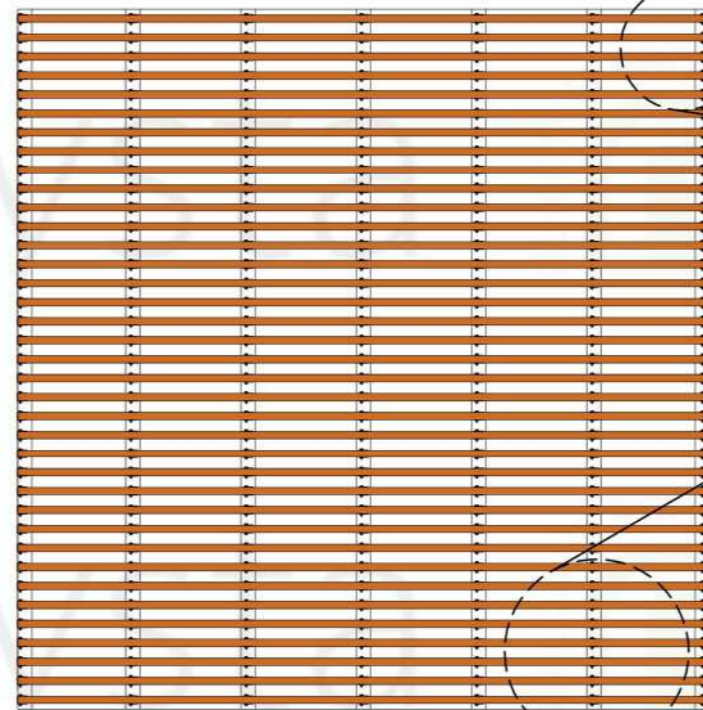

FRONT ELEVATION

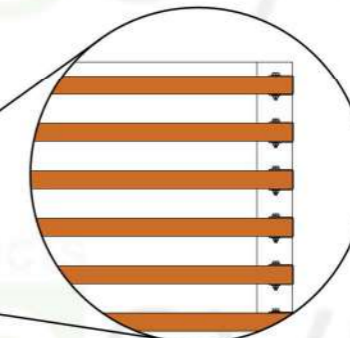

DETAIL-4.0

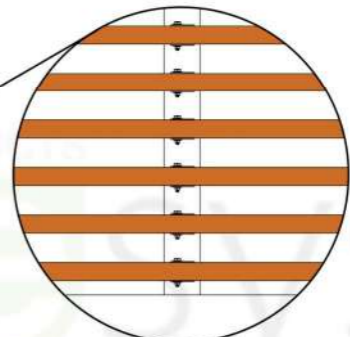

DETAIL-5.0

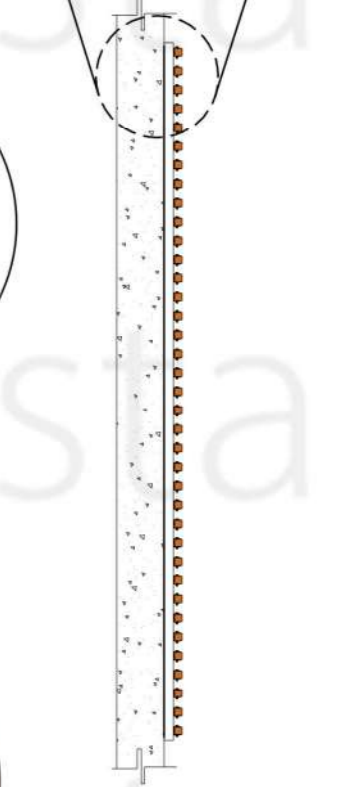

SIDE ELEVATION

1
1HCUB

1CH HORIZONTAL CLADDING U-BRACKET

RESYSTA PROFILE WITHOUT ALUMINUM INSERT (RESGC11211212)



NOTE

THIS DRAWING AS AN INSTRUMENT OF SERVICE, IS THE PROPERTY OF RESYSTA AND AS SUCH MUST NOT BE REPRODUCED OR COPIED IN PART OR IN WHOLE WITHOUT THE PERMISSION OF THE AUTHOR.

TITLE
1CH - U Bracket
HORIZONTAL CLADDING
DETAIL

SPECIFICATION
TYPICAL DRAWING
DETAIL

CAD BY:
C.R.E

CHECKED BY:

SHEET CONTENT
PERSPECTIVE
TOP VIEW
FRONT ELEVATION
SIDE ELEVATION
MULTI-BOARD SIDE ELEVATION

SHEET SIZE
A3
DATE
20.09.24

DRAWING NO.
1HCUB-1.1
REVISION
0

CONTINENT
RESYSTA
USA

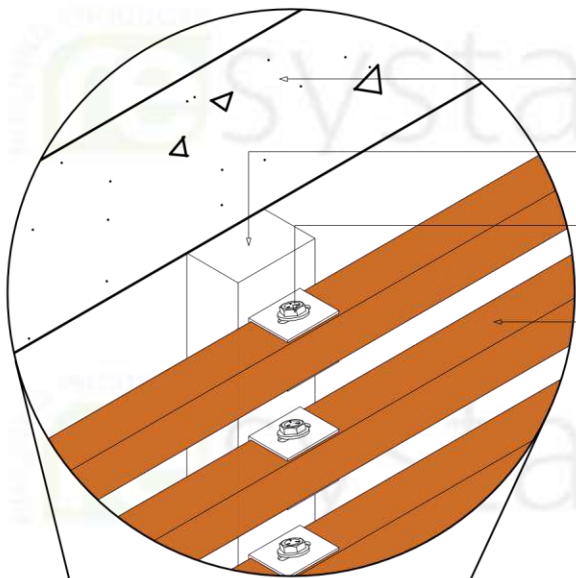

DETAIL - 2.0
MIDDLE PART

- EXISTING WALL
- SUBSTRUCTURE BY OTHERS
- RESUB112112 Aluminum U-Bracket with Bolt, washer and nut
- RESGC112112 Cladding (1CH)

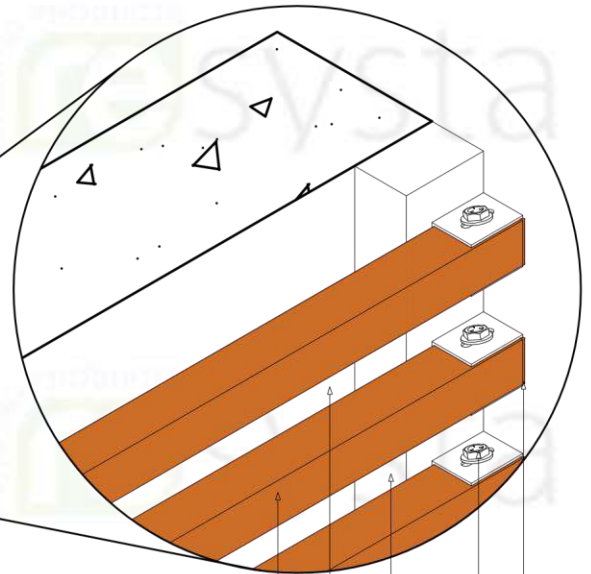

DETAIL - 1.0
END PART

- RESGC112112 Cladding (1CH)
- EXISTING WALL
- SUBSTRUCTURE BY OTHERS
- RESUB112112 Aluminum U-Bracket with Bolt, washer and nut
- RESCAP0206Cxx Hollow Cap

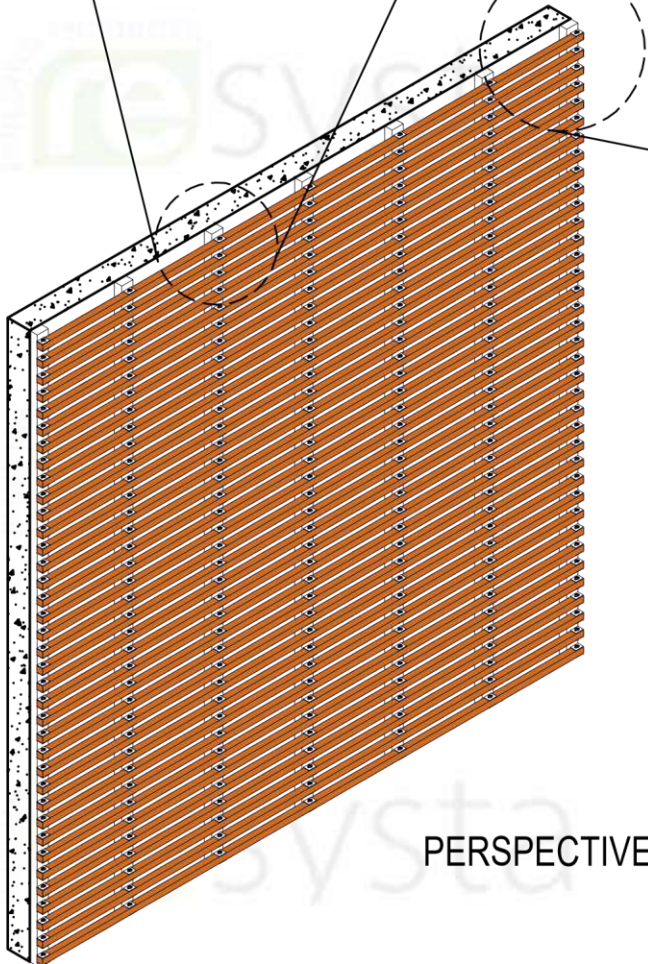

PERSPECTIVE

SUB-DETAIL
1HCUB 1.2

N.T.S

DIMENSION LEGEND	
Millimeter (mm)	
Inches (") / Foot (')	



NOTE
THIS DRAWING AS AN INSTRUMENT OF SERVICE, IS THE PROPERTY OF RESYSTA AND AS SUCH MUST NOT BE REPRODUCED OR COPIED IN PART OR IN WHOLE WITHOUT THE PERMISSION OF THE AUTHOR.

TITLE	SHEET CONTENT	CONTINENT
1CH - U BRACKET HORIZONTAL CLADDING SUB-DETAIL	PERSPECTIVE	RESYSTA USA
	DETAIL -1.0	
	DETAIL -2.0	
SPECIFICATION	DRAWING NO.	DATE
TYPICAL DRAWING DETAIL	1HCUB-12	20.09.24
	CAD BY:	CHECKED BY:
	C.R.E	

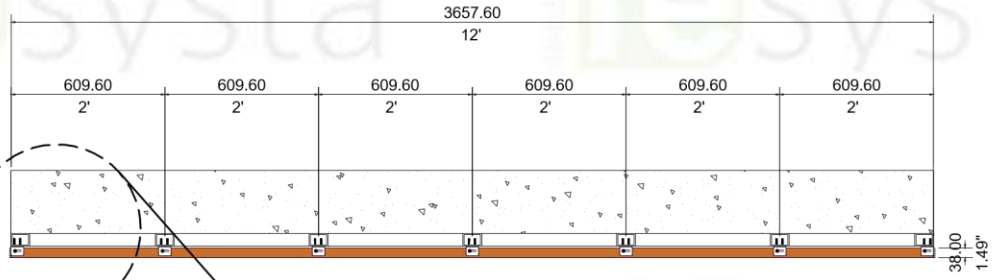

TOP VIEW

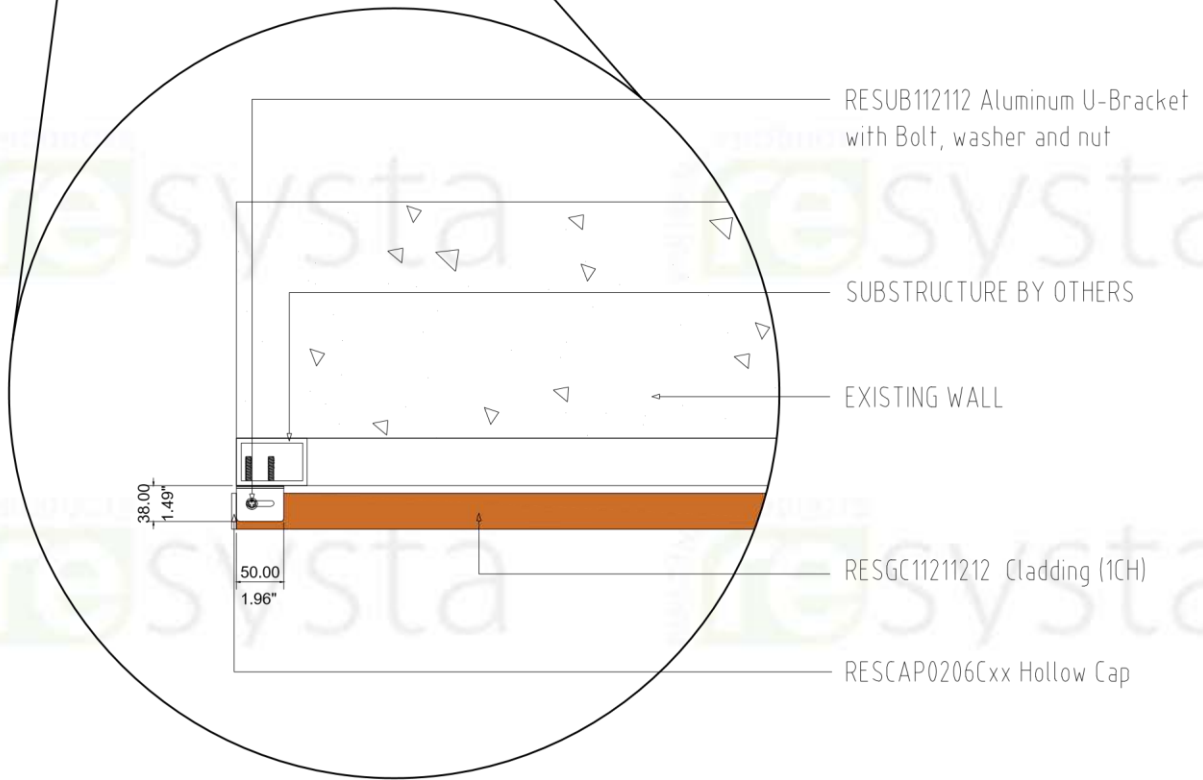

DETAIL - 3.0

SUB-DETAIL
1HCUB 1.3

N.T.S

DIMENSION LEGEND	
Millimeter (mm)	
Inches (") / Foot (')	



NOTE
THIS DRAWING AS AN INSTRUMENT OF SERVICE, IS THE PROPERTY OF RESYSTA AND AS SUCH MUST NOT BE REPRODUCED OR COPIED IN PART OR IN WHOLE WITHOUT THE PERMISSION OF THE AUTHOR.

TITLE	SHEET CONTENT	CONTINENT
1CH - U BRACKET HORIZONTAL CLADDING SUB-DETAIL	TOP VIEW	RESYSTA USA
	DETAIL - 3.0	
SPECIFICATION	DRAWING NO.	DATE
	1HCUB-13	20.09.24
	CAD BY:	CHECKED BY:
TYPICAL DRAWING DETAIL	C.R.E	

RESCAP0206Cxx
Hollow Cap

SUBSTRUCTURE BY
OTHERS

RESUB112112 Aluminum
U-Bracket with Bolt,
washer and nut

RESGC11211212
Cladding (1CH)

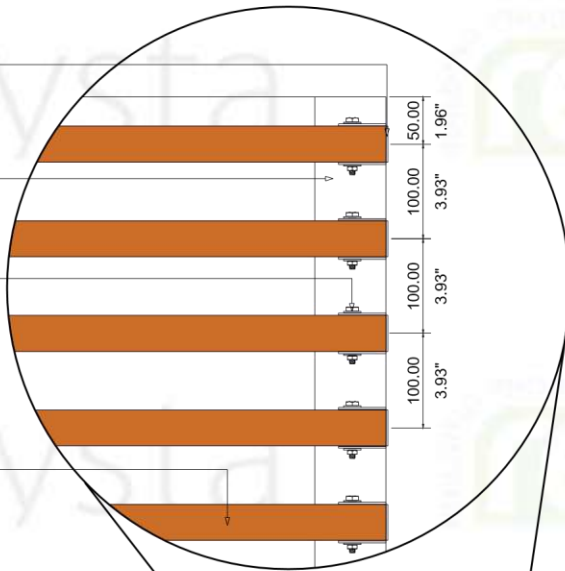

DETAIL - 4.0

RESGC11211212
Cladding (1CH)

SUBSTRUCTURE BY
OTHERS

RESUB112112
Aluminum U-Bracket
with Bolt, washer
and nut

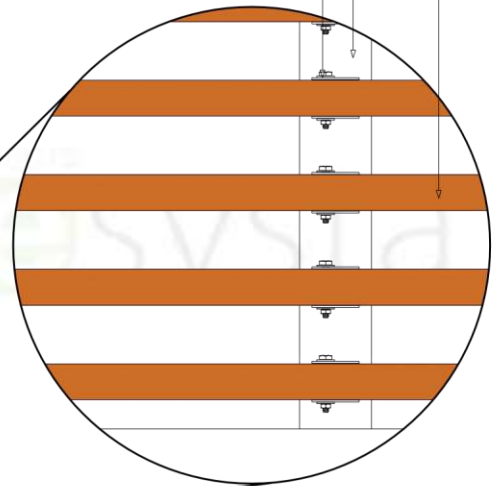

DETAIL - 5.0

SUB-DETAIL
1HCUB 1.4

N.T.S

DIMENSION LEGEND	
Millimeter (mm)	
Inches (") / Foot (')	

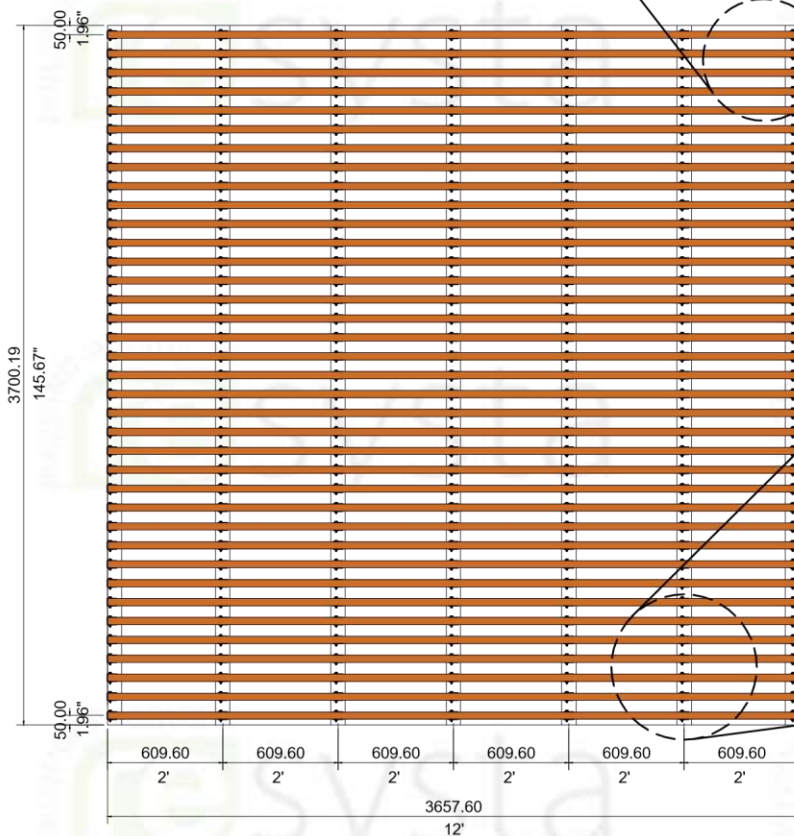

FRONT ELEVATION



NOTE

THIS DRAWING AS AN INSTRUMENT OF SERVICE, IS THE PROPERTY OF RESYSTA AND AS SUCH MUST NOT BE REPRODUCED OR COPIED IN PART OR IN WHOLE WITHOUT THE PERMISSION OF THE AUTHOR.

TITLE	SHEET CONTENT	CONTINENT	
1CH - U BRACKET HORIZONTAL CLADDING SUB-DETAIL	FRONT ELEVATION	RESYSTA USA	
	DETAIL-4.0		
	DETAIL-5.0		
SPECIFICATION	DRAWING NO.	DATE	
TYPICAL DRAWING DETAIL	1HCUB-14	20.09.24	
	CAD BY:	CHECKED BY:	
	C.R.E		

1/8" Diameter hole for every chamber for ventilation

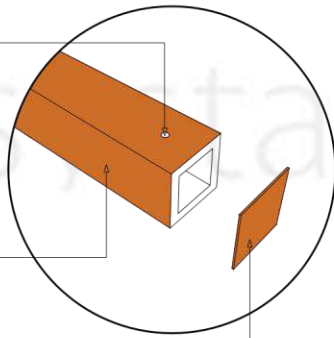

RESGC11211212 Cladding (1CH)

RESCAP0206Cxx Hollow Cap

NOTE:

If applying veneer caps to both ends of the RESGC11211212 you'll need to drill a 1/8" minimum diameter hole in every chamber to allow for ventilation. The location of the holes will depend on the Client's discretion based on the actual project conditions.

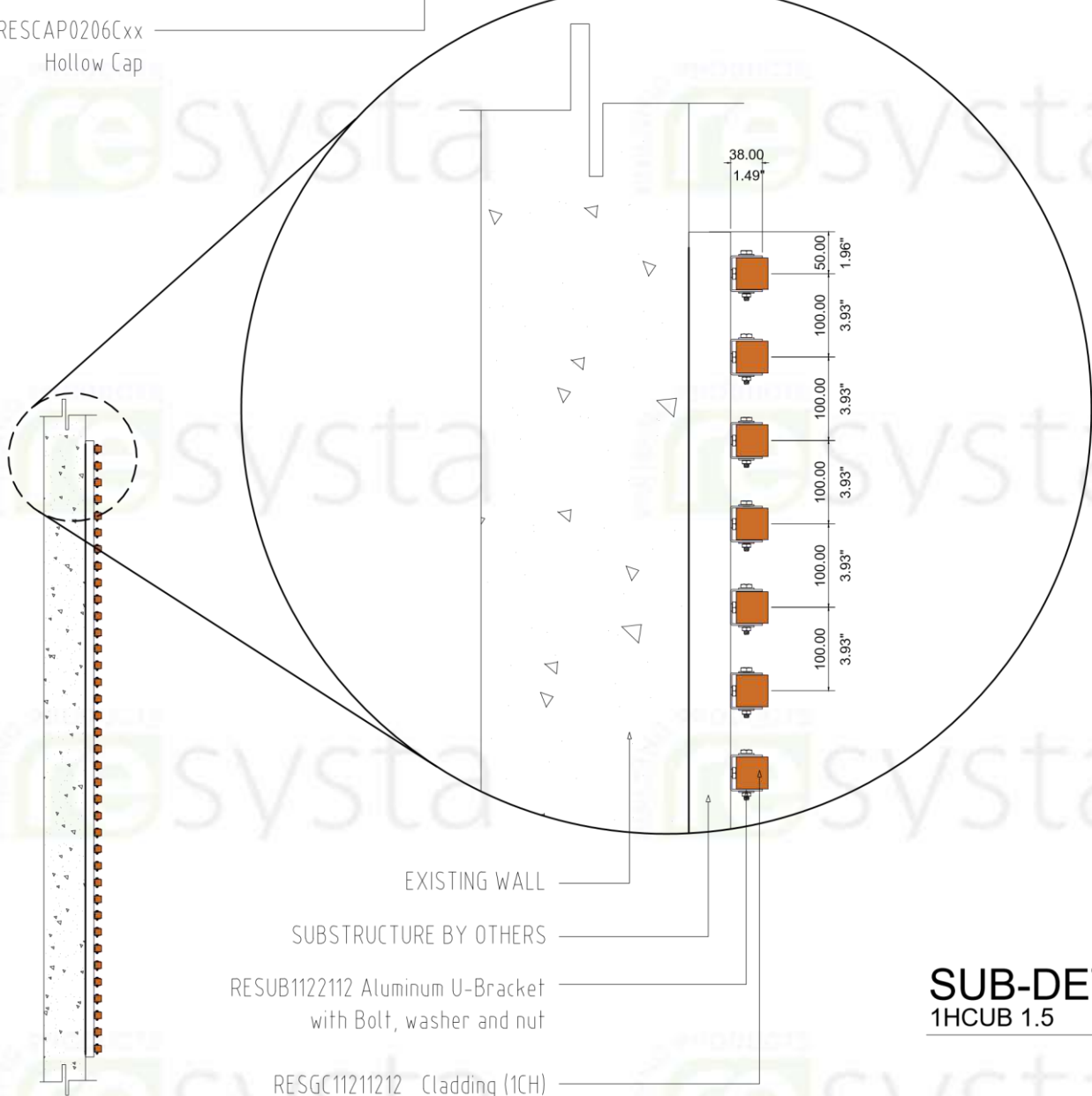

SIDE ELEVATION

DETAIL - 6.0

SUB-DETAIL
1HCUB 1.5

N.T.S

DIMENSION LEGEND	
Millimeter (mm)	Inches (") / Foot (')



NOTE
THIS DRAWING AS AN INSTRUMENT OF SERVICE, IS THE PROPERTY OF RESYSTA AND AS SUCH MUST NOT BE REPRODUCED OR COPIED IN PART OR IN WHOLE WITHOUT THE PERMISSION OF THE AUTHOR.

TITLE	SHEET CONTENT	CONTINENT
1CH - U BRACKET HORIZONTAL CLADDING SUB-DETAIL	SIDE ELEVATION DETAIL-6.0	RESYSTA USA
SPECIFICATION	DRAWING NO.	DATE
TYPICAL DRAWING DETAIL	1HCUB-15	20.09.24
	CAD BY:	CHECKED BY:
	C.R.E	

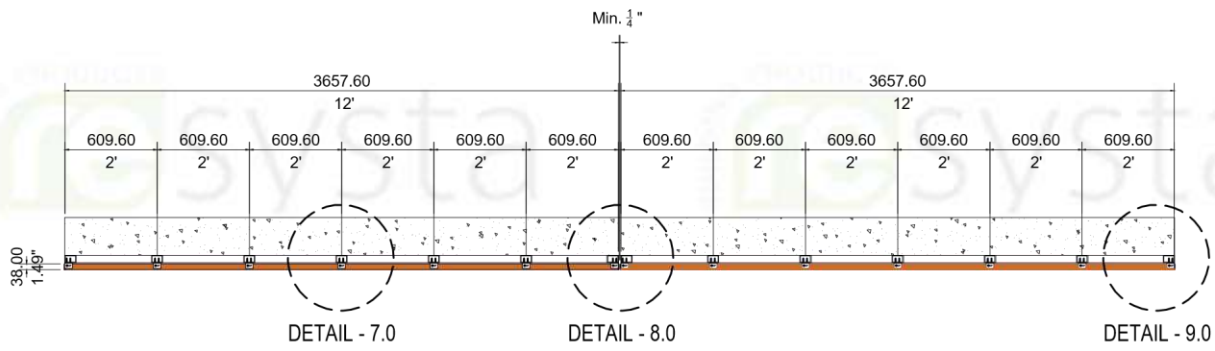

MULTI-BOARD TOP VIEW

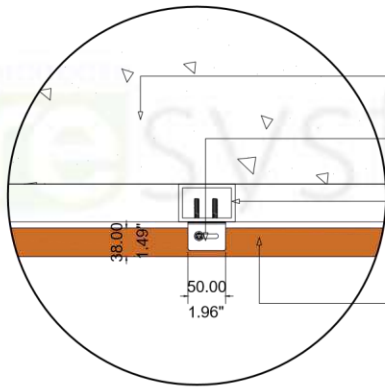

DETAIL - 7.0

- EXISTING WALL
- RESUB112112 Aluminum U-Bracket with Bolt, washer and nut
- SUBSTRUCTURE BY OTHERS
- RESGC11211212 Cladding (1CH)

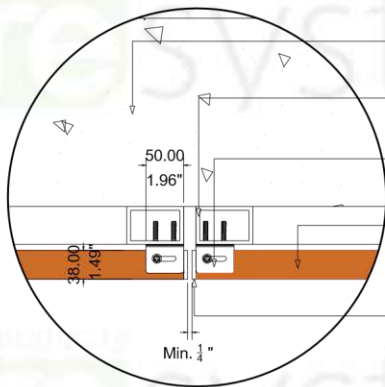

DETAIL - 8.0

- EXISTING WALL
- SUBSTRUCTURE BY OTHERS
- RESUB112112 Aluminum U-Bracket with Bolt, washer and nut
- RESGC11211212 Cladding (1CH)
- RESCAP0206Cxx Hollow Cap

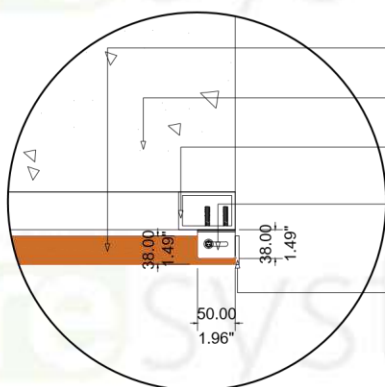

DETAIL - 9.0

- RESGC11211212 Cladding (1CH)
- EXISTING WALL
- SUBSTRUCTURE BY OTHERS
- RESUB112112 Aluminum U-Bracket with Bolt, washer and nut
- RESCAP0206Cxx Hollow Cap

SUB-DETAIL 1HCUB 1.6

N.T.S

DIMENSION LEGEND	
Millimeter (mm)	Inches (") / Foot (')



NOTE
THIS DRAWING AS AN INSTRUMENT OF SERVICE, IS THE PROPERTY OF RESYSTA AND AS SUCH MUST NOT BE REPRODUCED OR COPIED IN PART OR IN WHOLE WITHOUT THE PERMISSION OF THE AUTHOR.

TITLE	SHEET CONTENT	CONTINENT	
1CH - U BRACKET HORIZONTAL CLADDING SUB-DETAIL	MULTI-BRD TOP VIEW	RESYSTA USA	
	DETAIL-7.0		
	DETAIL-8.0		
SPECIFICATION	DETAIL-9.0	DRAWING NO.	DATE
	TYPICAL DRAWING DETAIL	1HCUB-16	20.09.24
		CAD BY: C.R.E.	CHECKED BY: