

DIMENSION LEGEND

Millimeter (mm)
Inches (") / Foot (')

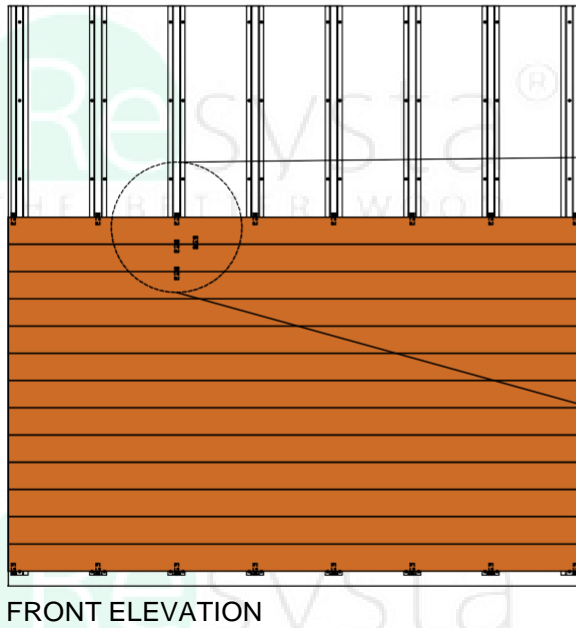
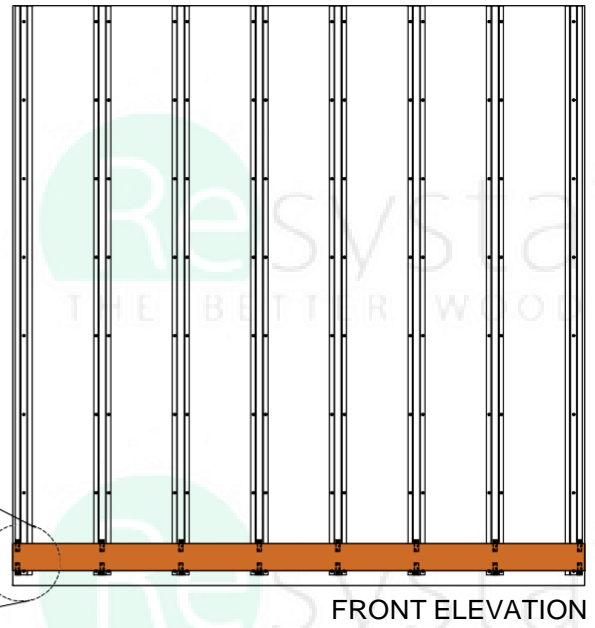
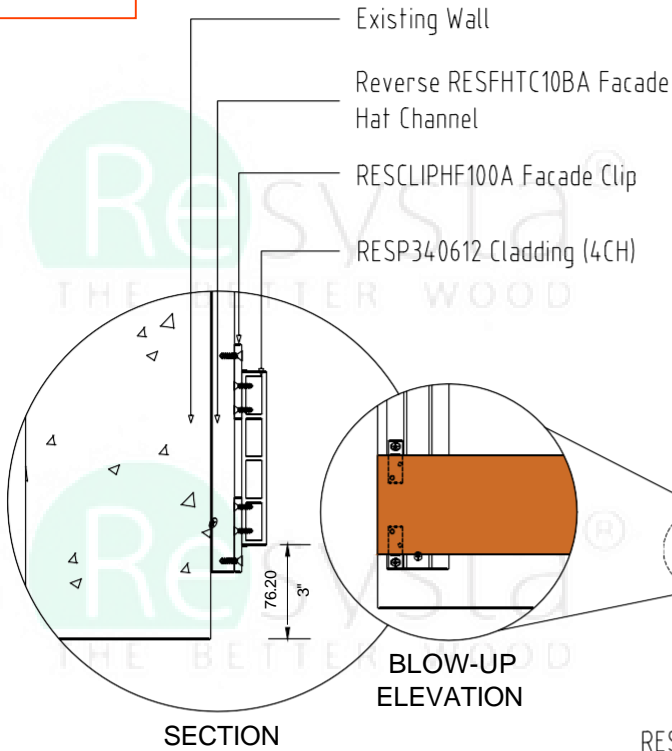

SUB-DETAIL

BJHCD 1.1

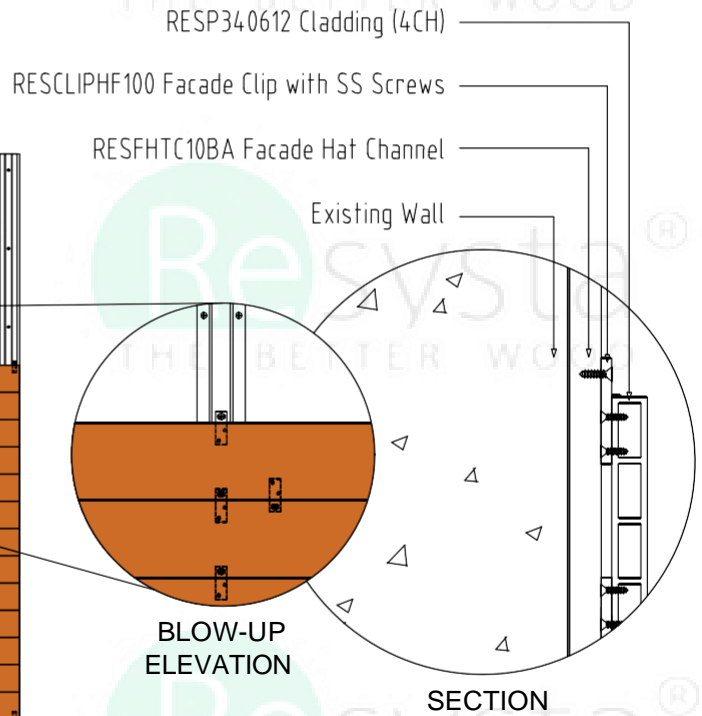

Note:

Each HF Clip requires 3 screws. Two are #8 x 1/2" SMS screws to attach the Clip to the Resysta Wall Cladding board and one is to attach the wall cladding board with the clip to the battens.



NOTE

THIS DRAWING AS AN INSTRUMENT OF SERVICE, IS THE PROPERTY OF RESYSTA AND AS SUCH MUST NOT BE REPRODUCED OR COPIED IN PART OR IN WHOLE WITHOUT THE PERMISSION OF THE AUTHOR.

TITLE
BUTT JOINT
HORIZONTAL CLADDING
SUB-DETAIL

SPECIFICATION
TYPICAL DRAWING DETAIL

SHEET CONTENT	
ELEVATION	
BLOW-UP DETAIL	
SECTION	
DRAWING NO.	DATE
BJHCD-02	21.07.22
CAD BY:	CHECKED BY:
M.T.C.	C.R.E

DIMENSION LEGEND

Millimeter (mm)

Inches (") / Foot (')

RESCLIPHF100A Facade Clip

Reverse RESFHTC10BA

Facade Hat Channel

RESP340612 Cladding (4CH)

Existing Wall

BLOW-UP
ELEVATION

TOP VIEW

FRONT ELEVATION

SUB-DETAIL

BJHCD 1.2



RESCLIPHF100A Facade Clip

Existing Wall

Reverse RESFHTC10BA

Facade Hat Channel

RESP340612 Cladding (4CH)

Table 1.4 "Resysta Expansion"

Resysta Wall Cladding Board Gap Guide					
	Gap of Wall cladding Board				Multi Board Gap
Temperature at Installation	Below 30 OF	60 OF	90 OF	120 OF	
Amount for Wall cladding Profile - Length of 12 ft.	7/16"	5/16"	3/16"	0"	1/4"

ISOMETRIC
VIEW

Note :

This is an option for installation using 3 or more boards abutted end-to-end. When connecting wall cladding boards at the ends, please consider Resysta Expansion.



NOTE

THIS DRAWING AS AN INSTRUMENT OF SERVICE, IS THE PROPERTY OF RESYSTA AND AS SUCH MUST NOT BE REPRODUCED OR COPIED IN PART OR IN WHOLE WITHOUT THE PERMISSION OF THE AUTHOR.

TITLE

BUTT JOINT
HORIZONTAL CLADDING
SUB-DETAIL

SPECIFICATION

TYPICAL DRAWING DETAIL

SHEET CONTENT

ELEVATION
BLOW-UP DETAIL
TOP VIEW

DRAWING NO.

BJHCD-03

CAD BY:

M.T.C.

DATE

21.07.22

CHECKED BY:

C.R.E.

DIMENSION LEGEND

Millimeter (mm)
Inches (") / Foot (')

Reverse RESFHTC10BA
Facade Hat Channel

RESCLIPHF100A Facade Clip

RESP340612 Cladding (4CH)

Existing Wall

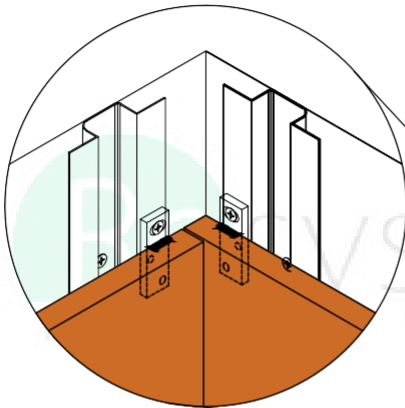

BLOW-UP
ISOMETRIC

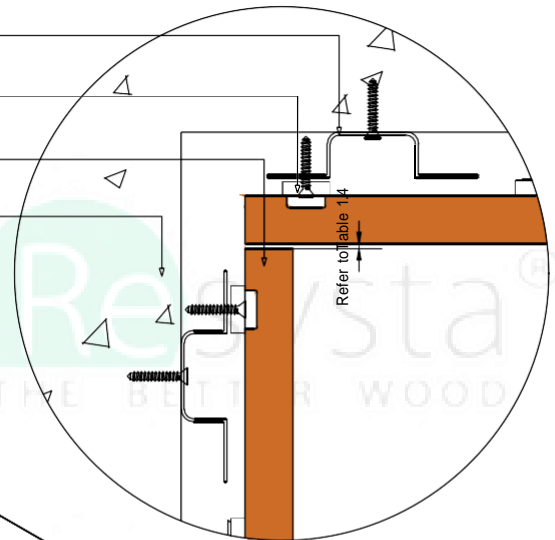

TOP VIEW

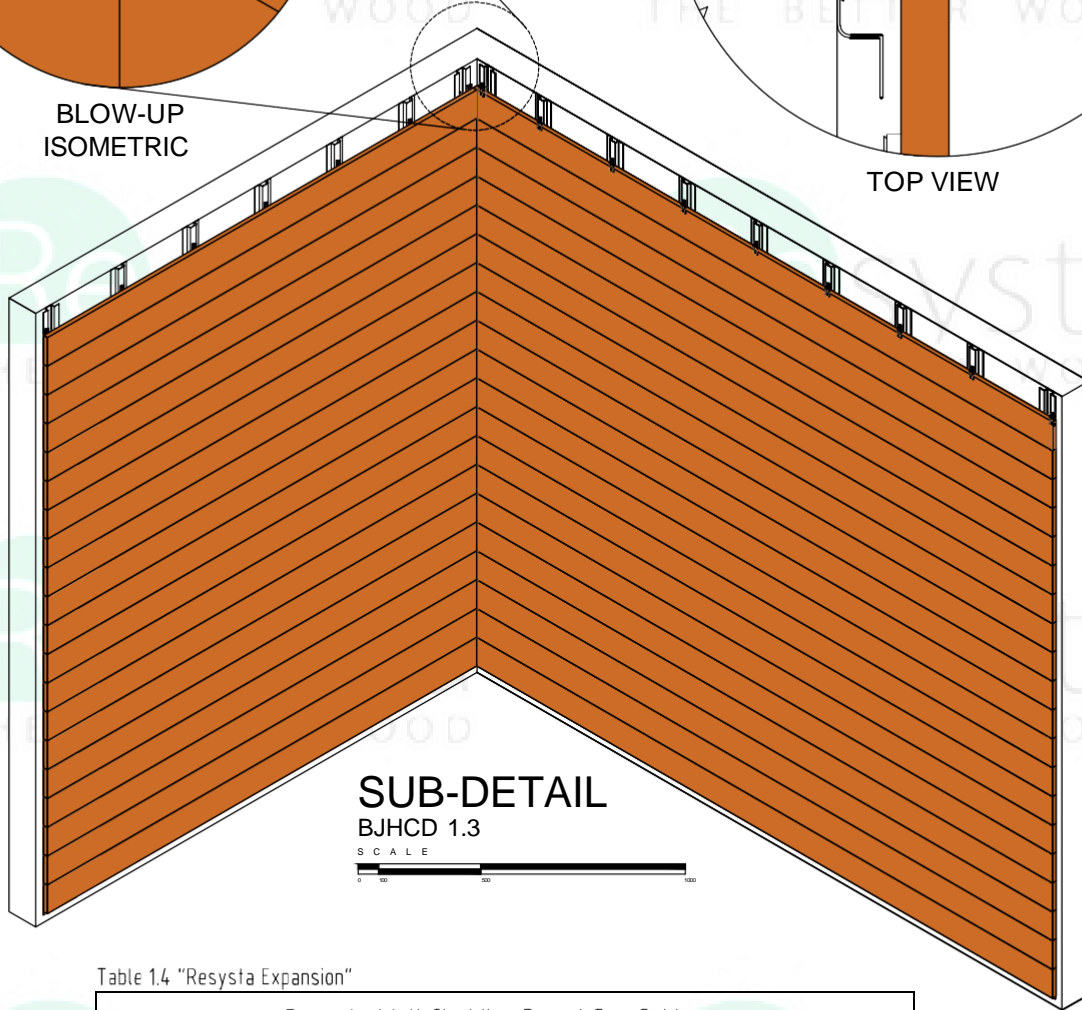

SUB-DETAIL

BJHCD 1.3

SCALE



Table 1.4 "Resysta Expansion"

Resysta Wall Cladding Board Gap Guide					
	Gap of Wall cladding Board				Multi Board Gap
Temperature at Installation	Below 30 OF	60 OF	90 OF	120 OF	
Amount for Wall cladding Profile - Length of 12 ft.	7/16"	5/16"	3/16"	0"	1/4"

ISOMETRIC
VIEW

Note :

When connecting wall cladding boards at the ends, please consider Resysta Expansion.

Resysta[®]
THE BETTER WOOD

NOTE

THIS DRAWING AS AN INSTRUMENT OF SERVICE, IS THE PROPERTY OF RESYSTA AND AS SUCH MUST NOT BE REPRODUCED OR COPIED IN PART OR IN WHOLE WITHOUT THE PERMISSION OF THE AUTHOR.

TITLE
BUTT JOINT
HORIZONTAL CLADDING
SUB-DETAIL

SPECIFICATION
TYPICAL DRAWING DETAIL

SHEET CONTENT	
ISOMETRIC VIEW	
BLOW-UP DETAIL	
TOP VIEW	
DRAWING NO.	DATE
BJHCD-04	21.07.22
CAD BY:	CHECKED BY:
M.T.C.	C.R.E

DIMENSION LEGEND

Millimeter (mm)

Inches (") / Foot (')

Hollow Cap

RESP340612 Cladding (4CH)

Reverse RESFHTC10BA

Facade Hat Channel

RESCLIPHF100A Facade Clip

Existing Wall

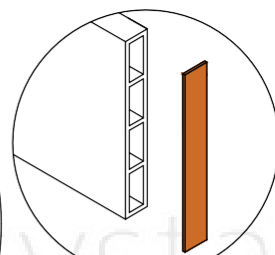
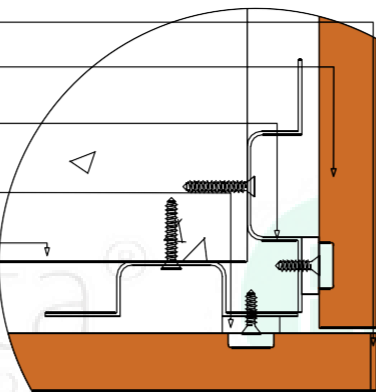

HOLLOW CAP
ISOMETRIC VIEW

TOP VIEW

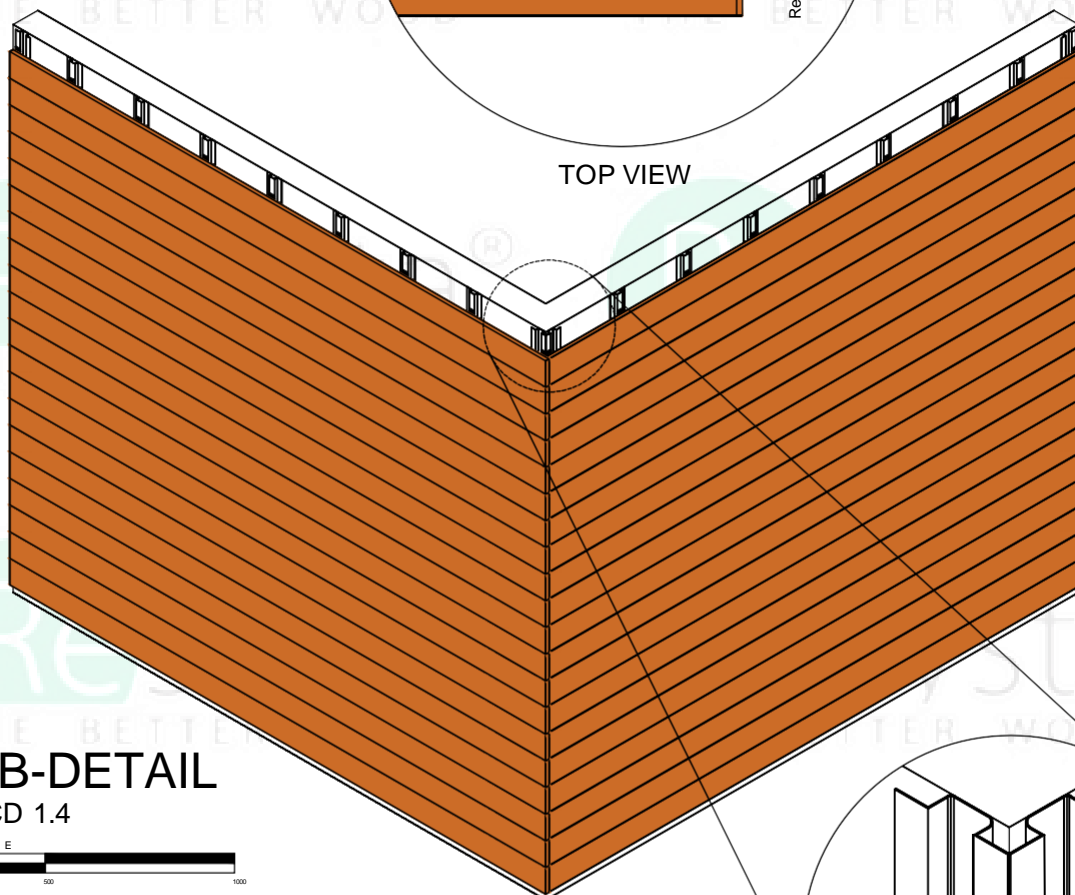

SUB-DETAIL

BJHCD 1.4

SCALE

0 100 500 1000

ISOMETRIC VIEW

Table 1.4 "Resysta Expansion"

Resysta Wall Cladding Board Gap Guide					
	Gap of Wall cladding Board				Multi Board Gap
Temperature at Installation	Below 30 OF	60 OF	90 OF	120 OF	
Amount for Wall cladding Profile - Length of 12 ft.	7/16"	5/16"	3/16"	0"	1/4"

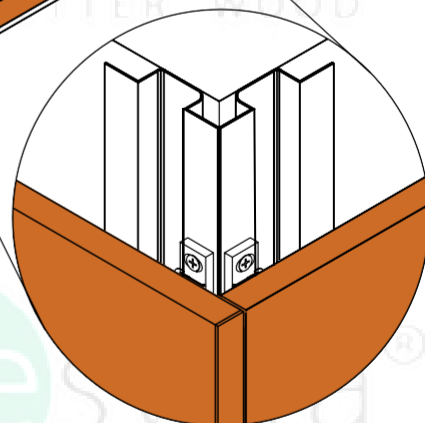

BLOW-UP
ISOMETRIC

Note :

Remove adhesive strip cover film. Center Hollow Cap on the end of the plank and apply with firm pressure all around the center supports.



NOTE

THIS DRAWING AS AN INSTRUMENT OF SERVICE, IS THE PROPERTY OF RESYSTA AND AS SUCH MUST NOT BE REPRODUCED OR COPIED IN PART OR IN WHOLE WITHOUT THE PERMISSION OF THE AUTHOR.

TITLE

BUTT JOINT
HORIZONTAL CLADDING
SUB-DETAIL

SPECIFICATION

TYPICAL DRAWING DETAIL

SHEET CONTENT

ISOMETRIC VIEW
BLOW-UP DETAIL
TOP VIEW

DRAWING NO.

BJHCD-05

CAD BY:

M.T.C.

DATE

21.07.22

CHECKED BY:

C.R.E

DIMENSION LEGEND

Millimeter (mm)

Inches (") / Foot (')

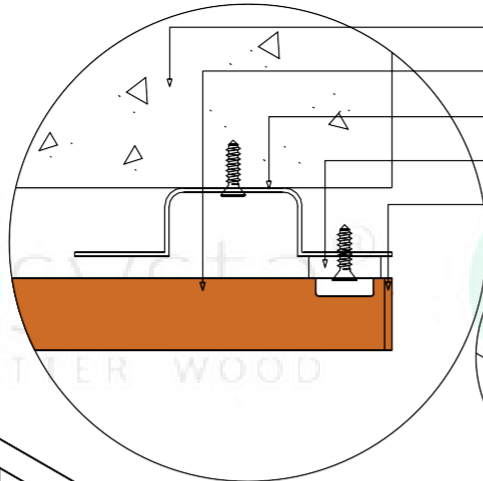

TOP VIEW

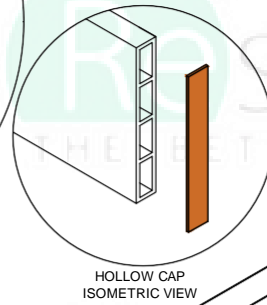

HOLLOW CAP
ISOMETRIC VIEW

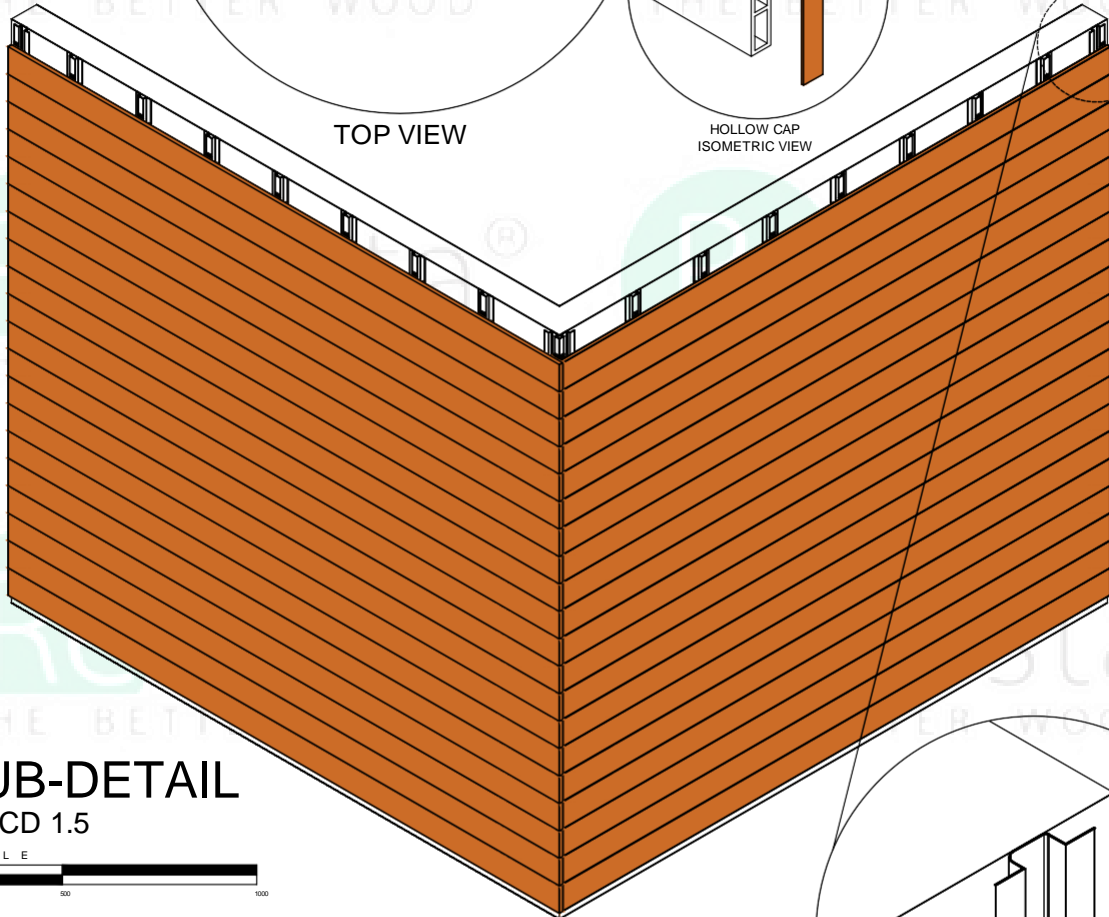

ISOMETRIC VIEW

SUB-DETAIL

BJHCD 1.5



Table 1.4 "Resysta Expansion"

Resysta Wall Cladding Board Gap Guide					
	Gap of Wall cladding Board				Multi Board Gap
Temperature at Installation	Below 30 OF	60 OF	90 OF	120 OF	
Amount for Wall cladding Profile - Length of 12 ft.	7/16"	5/16"	3/16"	0"	1/4"

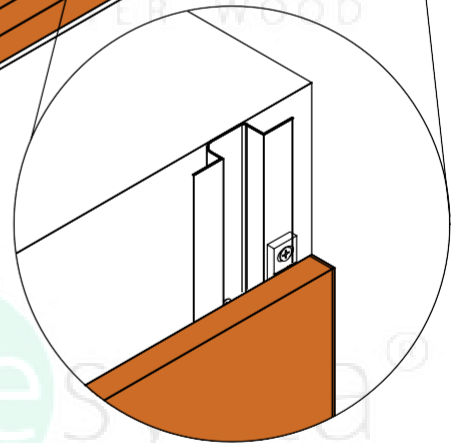

BLOW-UP ISOMETRIC

Note :

Be sure that all surfaces are clean and free of debris such as dust, dirt, oils and paints. Remove adhesive strip cover film. Center Hollow Cap on the end of the plank and apply with firm pressure all around the center supports.



NOTE

THIS DRAWING AS AN INSTRUMENT OF SERVICE, IS THE PROPERTY OF RESYSTA AND AS SUCH MUST NOT BE REPRODUCED OR COPIED IN PART OR IN WHOLE WITHOUT THE PERMISSION OF THE AUTHOR.

TITLE

BUTT JOINT
HORIZONTAL CLADDING
SUB-DETAIL

SPECIFICATION

TYPICAL DRAWING DETAIL

SHEET CONTENT

ISOMETRIC VIEW
BLOW-UP DETAIL
TOP VIEW

DRAWING NO.

BJHCD-06

CAD BY:

M.T.C.

DATE

21.07.22

CHECKED BY:

C.R.E