

INSIDE CORNER MOLD
(SEE SUB-DETAIL ATVSD-1.2)

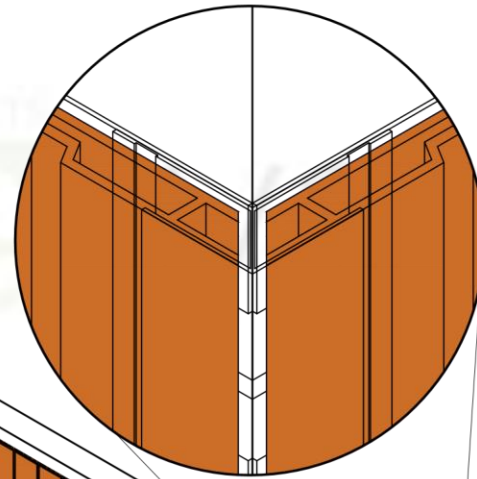

OUTSIDE CORNER MOLD
(SEE SUB-DETAIL ATVSD-1.3)

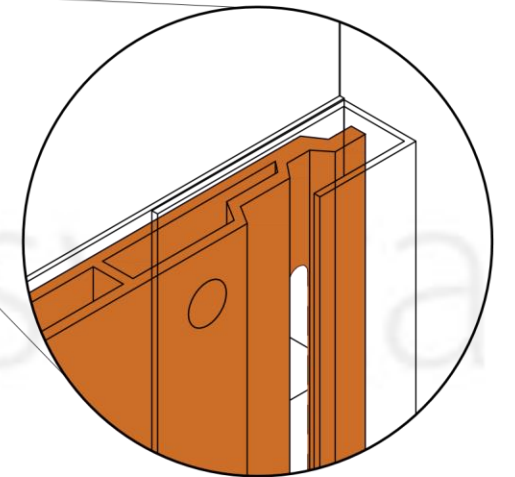

J-MOLD
(SEE SUB-DETAIL ATVSD-1.4)

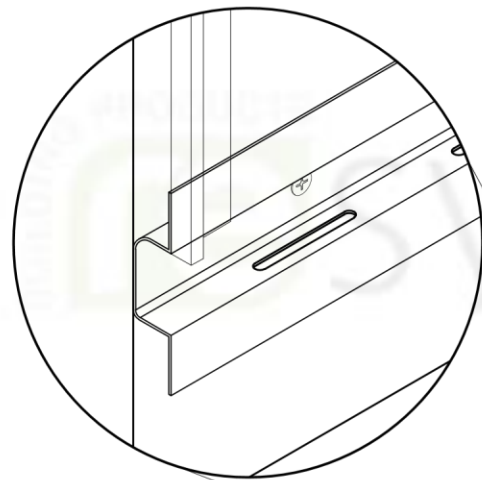

STARTET J STRIP
(SEE SUB-DETAIL ATVSD-1.1)

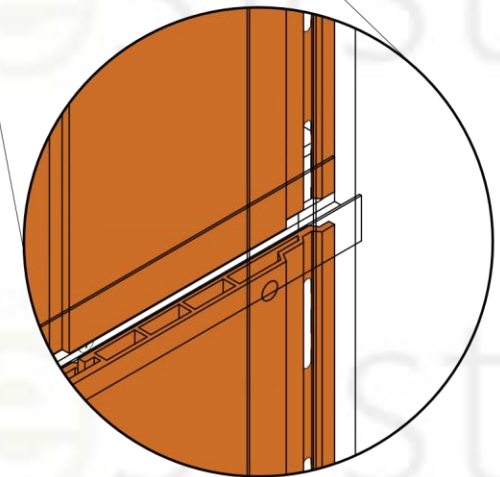

H-MOLD
(SEE SUB-DETAIL ATVSD-1.5)

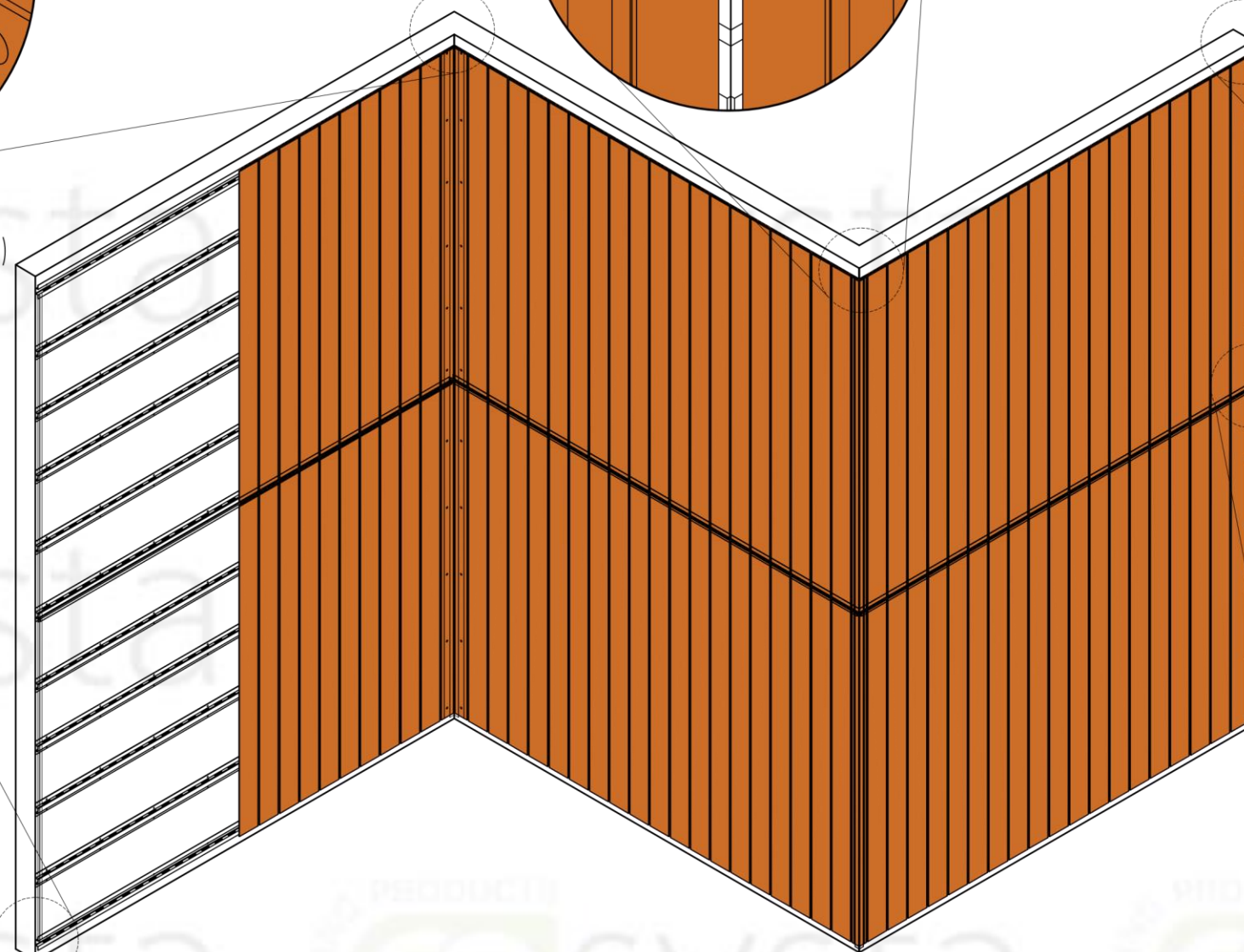

ISOMETRIC VIEW

1

ATVSD-1

ALUMINUM TRIM VERTICAL SIDING DETAIL (ATVSD)

N.T.S

BUILDING PRODUCTS
resysta

NOTE

THIS DRAWING, AS AN INSTRUMENT OF SERVICE, IS THE PROPERTY OF
RESYSTA
AND AS SUCH MUST NOT BE REPRODUCED OR COPIED IN PART OR IN WHOLE WITHOUT THE PERMISSION OF THE AUTHOR.

TITLE

ALUMINUM TRIM
VERTICAL SIDING
DETAIL

SPECIFICATION

TYPICAL DRAWING
DETAIL

CAD BY:

M.T.C.

CHECKED BY:

C.R.E.

SHEET CONTENT

ISOMETRIC VIEW

BLOW-UP DETAIL

SHEET SIZE

A3

DRAWING NO.

ATVSD-01

DATE

03.01.23

REVISION

0

CONTINENT

RESYSTA
USA

DIMENSION LEGEND

Millimeter (mm)
Inches (") / Foot (')

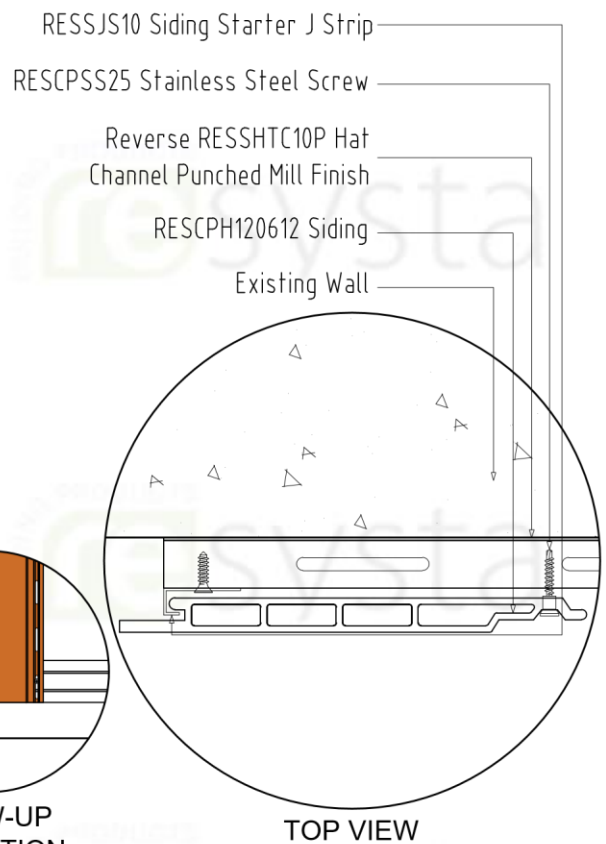
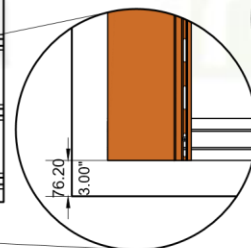
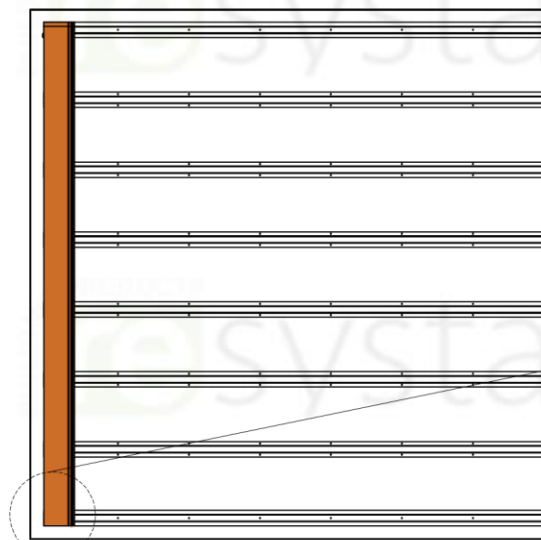
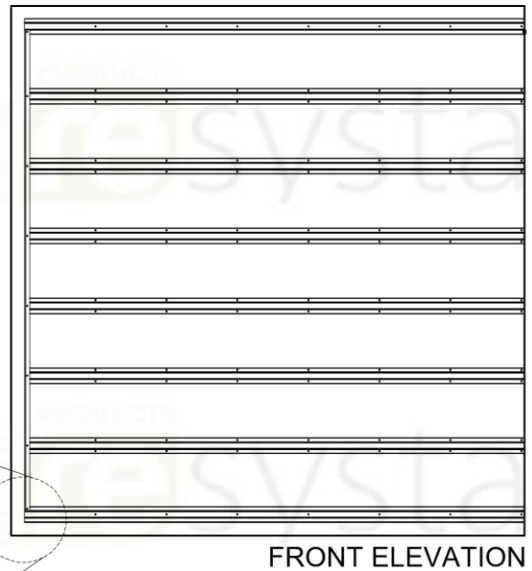
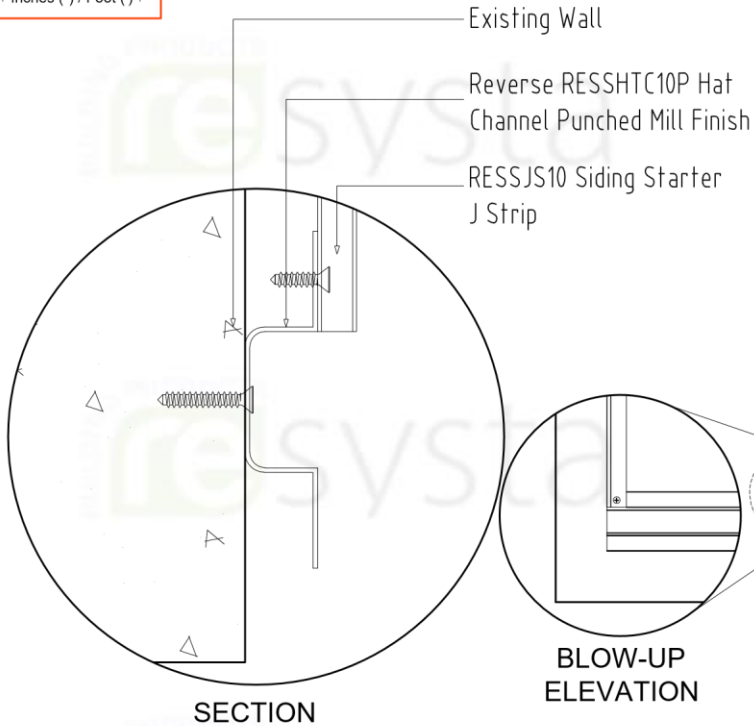

SUB-DETAIL
ATVSD 1.1
N.T.S

Note:

Aluminum starter strip is required to install the Resysta siding board. Attach the starter strip at the bottom of the battens following the fastener and spacing recommendations. The Resysta siding boards will hang 1/2" below the bottom of the starter strip therefore the starter strip should be attached accordingly as per the pre plan layout.

BUILDING PRODUCTS
resysta

NOTE

THIS DRAWING AS AN INSTRUMENT OF SERVICE, IS THE PROPERTY OF RESYSTA AND AS SUCH MUST NOT BE REPRODUCED OR COPIED IN PART OR IN WHOLE WITHOUT THE PERMISSION OF THE AUTHOR.

TITLE

ALUMINUM TRIM
VERTICAL SIDING
SUB-DETAIL

SPECIFICATION

TYPICAL DRAWING DETAIL

SHEET CONTENT

ELEVATION
BLOW-UP DETAIL
SECTION
TOP VIEW

DRAWING NO.

ATVSD-02

CAD BY:

M.T.C.

CONTINENT

RESYSTA
USA

DATE

03.01.23

CHECKED BY:

C.R.E

DIMENSION LEGEND

Millimeter (mm)
Inches (") / Foot (')

10mm / 0.40" Ø Veneer Cap

Reverse RESHTC10P Hat Channel Punched Mill Finish

RESCPH120612 Siding

RESSIC10 Inside Corner Mold

Gap_Refer to Table 1.4

RESCPS25 Stainless Steel Screw

Existing Wall

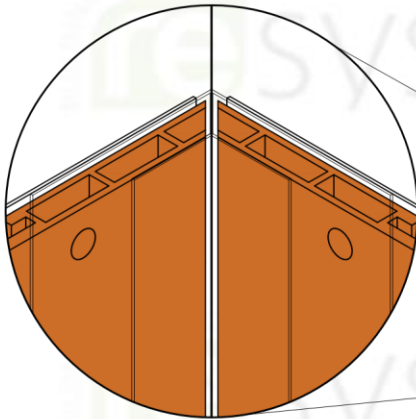

BLOW-UP
ISOMETRIC

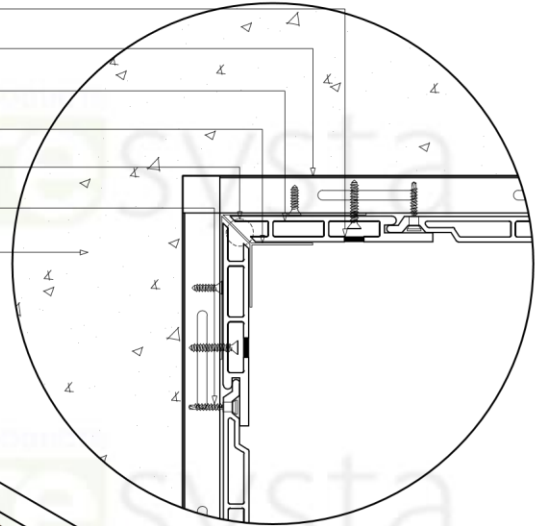

TOP VIEW

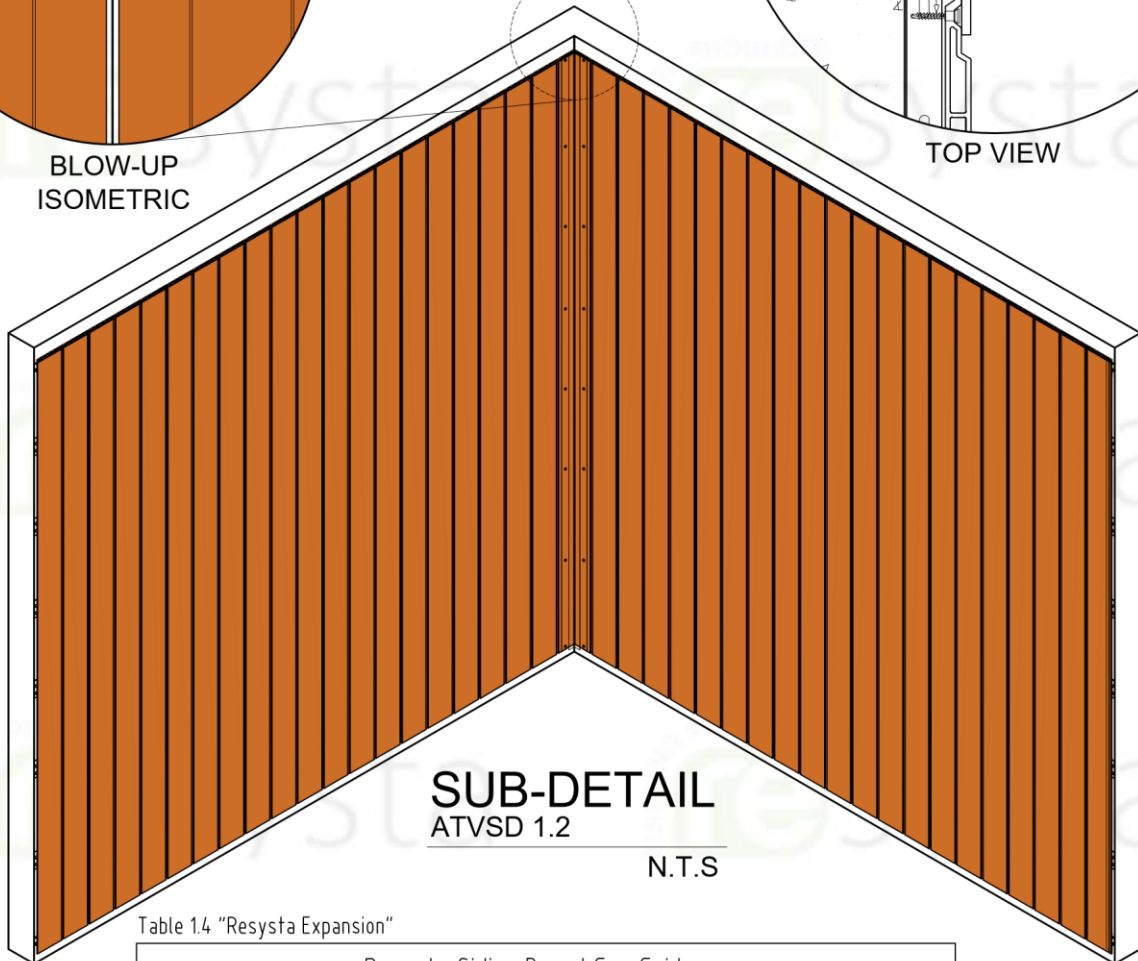

SUB-DETAIL

ATVSD 1.2

N.T.S

ISOMETRIC
VIEW

Table 1.4 "Resysta Expansion"

Resysta Siding Board Gap Guide					
Temperature at Installation	Aluminum Trim Gap of Siding Boards				H-Channel Gap
	Below 30°F	60°F	90°F	120°F	
Amount for Wall cladding Profile - Length of 12 ft.	7/16"	5/16"	3/16"	0"	1/4"

Note :

Inside corner trim should be pre-applied prior to installing siding boards. The starter strip for the first board should be installed butted against the corner trim, not overlapping the corner trim attachment. Follow the gap guide when installing the siding board to allow for expansion and contraction within the inside corner trim.

BUILDING PRODUCTS
resysta

NOTE

THIS DRAWING AS AN INSTRUMENT OF SERVICE, IS THE PROPERTY OF RESYSTA AND AS SUCH MUST NOT BE REPRODUCED OR COPIED IN PART OR IN WHOLE WITHOUT THE PERMISSION OF THE AUTHOR.

TITLE

ALUMINUM TRIM
VERTICAL SIDING
SUB-DETAIL

SPECIFICATION

TYPICAL DRAWING DETAIL

SHEET CONTENT

ISOMETRIC VIEW
BLOW-UP ISOMETRIC
TOP VIEW

DRAWING NO.

ATVSD-03

CAD BY:

M.T.C.

CONTINENT

RESYSTA
USA

DATE

03.01.23

CHECKED BY:

C.R.E

DIMENSION LEGEND

Millimeter (mm)
Inches (") / Foot (')

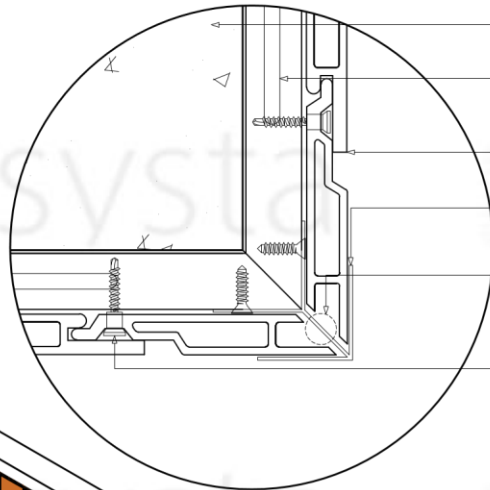

Existing Wall
Reverse RESSHTC10P Hat
Channel Punched Mill Finish
RESCPH120612 Siding
RESSOC10 Outside Corner
Gap_ Refer to Table 1.4
RESCPSS25 Stainless
Steel Screw

TOP VIEW

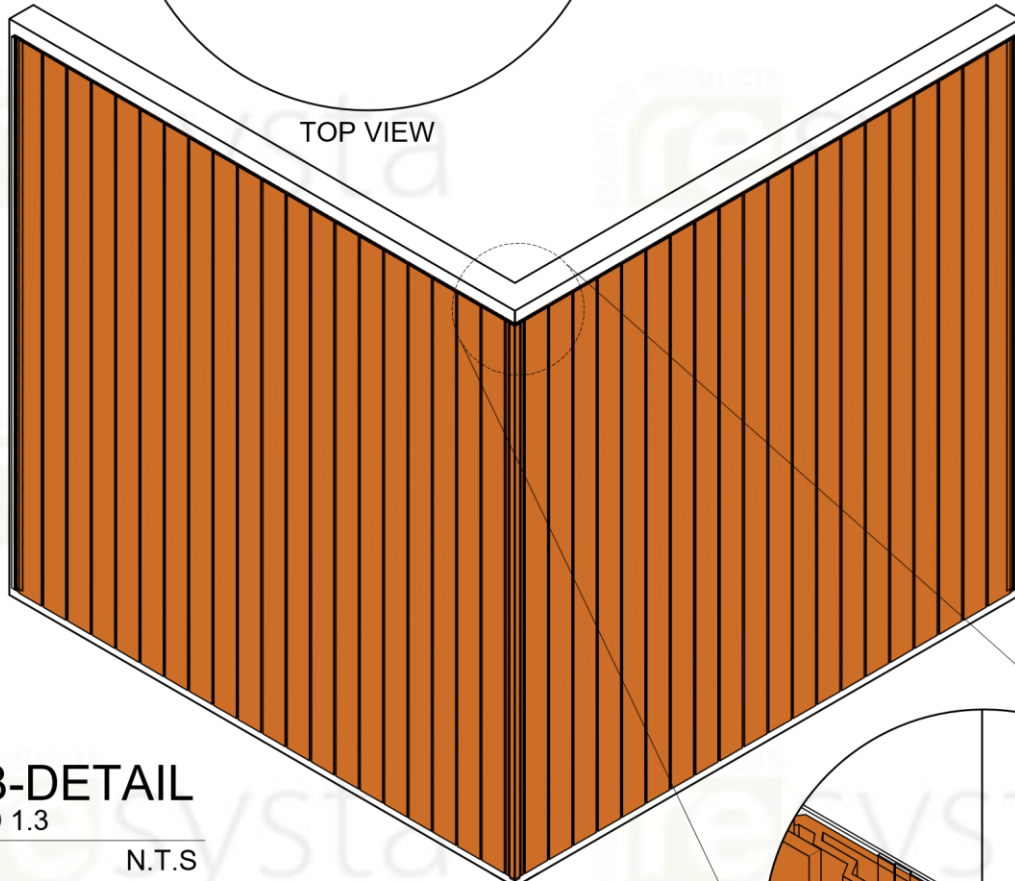

ISOMETRIC VIEW

SUB-DETAIL ATVSD 1.3

N.T.S

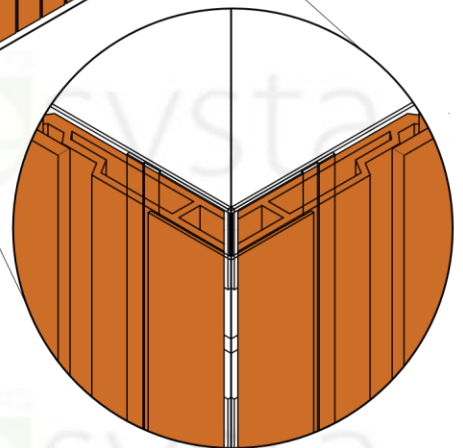

BLOW-UP ISOMETRIC

Table 1.4 "Resysta Expansion"

Resysta Siding Board Gap Guide					
Temperature at Installation	Aluminum Trim Gap of Siding Boards				H-Channel Gap
	Below 30°F	60°F	90°F	120°F	
Amount for Wall cladding Profile - Length of 12 ft.	7/16"	5/16"	3/16"	0"	1/4"

Note :

Outside corner trim should be pre applied prior to installing siding boards. The starter strip for the first board should be installed butted against the corner trim, not overlapping the corner trim attachment. The siding board end that is inserted into the outside corner should be miter cut at a 45 degree angle to match up with the outside corner internal web.

BUILDING PRODUCTS
resysta

NOTE

THIS DRAWING AS AN INSTRUMENT OF SERVICE, IS THE PROPERTY OF RESYSTA AND AS SUCH MUST NOT BE REPRODUCED OR COPIED IN PART OR IN WHOLE WITHOUT THE PERMISSION OF THE AUTHOR.

TITLE	SHEET CONTENT		CONTINENT
	ISOMETRIC VIEW	BLOW-UP ISOMETRIC	RESYSTA USA
SPECIFICATION	DRAWING NO.		DATE
	ATVSD-04		03.01.23
TYPICAL DRAWING DETAIL	CAD BY:		CHECKED BY:
	M.T.C.		C.R.E

DIMENSION LEGEND

Millimeter (mm)
Inches (") / Foot (')

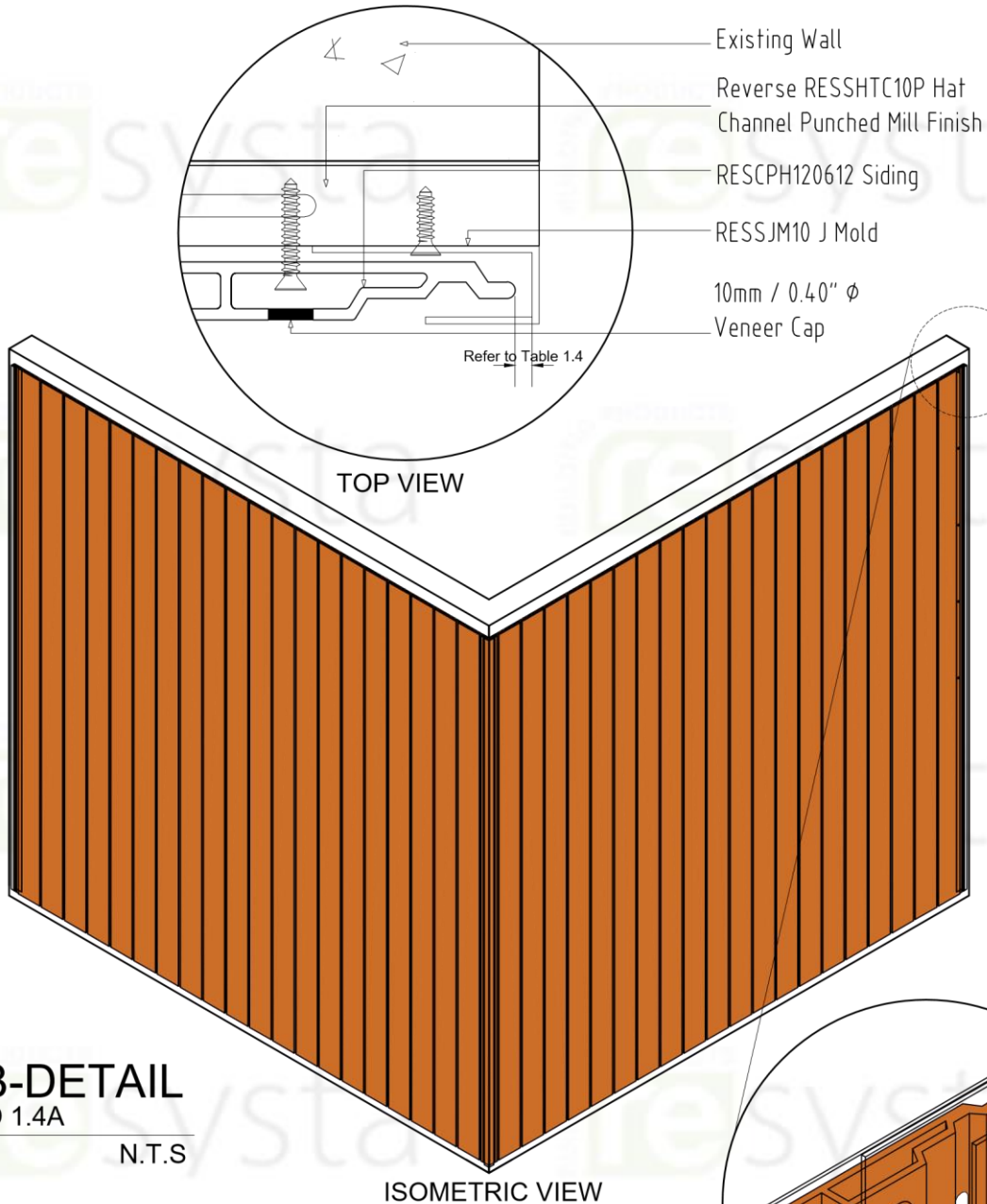

SUB-DETAIL ATVSD 1.4A

N.T.S

ISOMETRIC VIEW

Table 1.4 "Resysta Expansion"

Resysta Siding Board Gap Guide					
	Aluminum Trim Gap of Siding Boards				H-Channel Gap
Temperature at Installation	Below 30°F	60°F	90°F	120°F	
Amount for Wall cladding Profile - Length of 12 ft.	7/16"	5/16"	3/16"	0"	1/4"



BLOW-UP ISOMETRIC

Note :

When a siding board in either a horizontal or vertical application terminates into a wall, eave, window, door etc. a J-channel should be used to cover the exposed end of the siding board. The J-channel should also be used along the bottom of a vertical installation. J-channel trim should be pre-applied prior to installing siding boards.

BUILDING PRODUCTS
resysta

NOTE

THIS DRAWING AS AN INSTRUMENT OF SERVICE, IS THE PROPERTY OF RESYSTA AND AS SUCH MUST NOT BE REPRODUCED OR COPIED IN PART OR IN WHOLE WITHOUT THE PERMISSION OF THE AUTHOR.

TITLE	SHEET CONTENT	CONTINENT
ALUMINUM TRIM VERTICAL SIDING SUB-DETAIL	ISOMETRIC VIEW	RESYSTA USA
	BLOW-UP ISOMETRIC	
	TOP VIEW	
SPECIFICATION	DRAWING NO.	DATE
TYPICAL DRAWING DETAIL	ATVSD-05	03.01.23
	CAD BY:	CHECKED BY:
	M.T.C.	C.R.E

DIMENSION LEGEND

Millimeter (mm)
Inches (") / Foot (')

J Mold 3mm Ø Weep hole every 6"

RESSJM10 J Mold

RESCPH120612 Siding

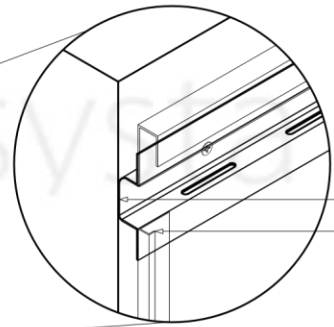

BLOW-UP ISOMETRIC

RESSJS10 Siding
Starter J Strip

Reverse RESSHTC10P Hat
Channel Punched Mill Finish

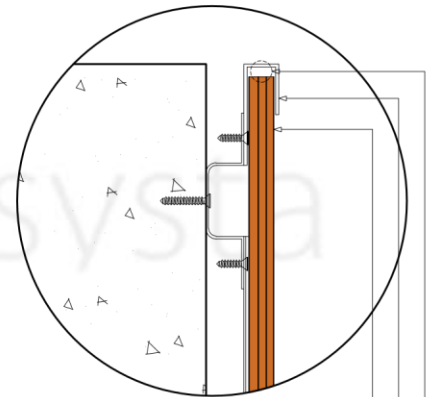

SECTION

RESCPH120612 Siding

RESSJM10 J Mold

Gap_Refer to Table 1.4

Reverse RESSHTC10P Hat
Channel Punched Mill Finish
RESSJS10 Siding Starter
J Strip

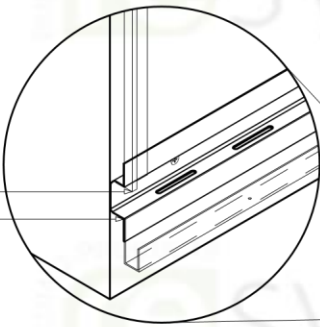

BLOW-UP ISOMETRIC

ISOMETRIC
VIEW

Table 1.4 "Resysta Expansion"

Resysta Siding Board Gap Guide					
	Aluminum Trim Gap of Siding Boards				H-Channel Gap
Temperature at Installation	Below 30°F	60°F	90°F	120°F	
Amount for Wall cladding Profile - Length of 12 ft.	7/16"	5/16"	3/16"	0"	1/4"

SUB-DETAIL ATVSD 1.4B

N.T.S

Note :

When a siding board in either a horizontal or vertical application terminates into a wall, eave, window, door etc. a J-channel should be used to cover the exposed end of the siding board. The J-channel should also be used along the bottom of a vertical installation. J-channel trim should be pre-applied prior to installing siding boards.

BUILDING PRODUCTS
resysta

NOTE

THIS DRAWING AS AN INSTRUMENT OF SERVICE, IS THE PROPERTY OF RESYSTA AND AS SUCH MUST NOT BE REPRODUCED OR COPIED IN PART OR IN WHOLE WITHOUT THE PERMISSION OF THE AUTHOR.

TITLE

ALUMINUM TRIM
VERTICAL SIDING
SUB-DETAIL

SPECIFICATION

TYPICAL DRAWING DETAIL

SHEET CONTENT

ISOMETRIC VIEW
BLOW-UP ISOMETRIC
SECTION

DRAWING NO.

ATVSD-06

CAD BY:

M.T.C.

CONTINENT

RESYSTA
USA

DATE

03.01.23

CHECKED BY:

C.R.E

DIMENSION LEGEND

Millimeter (mm)
Inches (") / Foot (')

RESSHTC10P Hat Channel
Punched Mill Finish

Existing Wall

BLOW-UP
ELEVATION

RESCPH120612 Siding

RESSHM10 Siding H Mold

FRONT ELEVATION

SECTION

Existing Wall

Gap_Refer to Table 1.4

RESSHM10 Siding H Mold

RESSHTC10P Hat Channel
Punched Mill Finish

RESCPH120612 Siding

ISOMETRIC VIEW

Table 1.4 "Resysta Expansion"

Resysta Siding Board Gap Guide					
	Aluminum Trim Gap of Siding Boards				H-Channel Gap
Temperature at Installation	Below 30°F	60°F	90°F	120°F	
Amount for Wall cladding Profile - Length of 12 ft.	7/16"	5/16"	3/16"	0"	1/4"

SUB-DETAIL
ATVSD 1.5

N.T.S

Note :

An H-Channel should be installed at each board abutment joint to cover the ends of the Resysta siding board. This is a option for installations using 3 or more boards abutted end-to-end

BUILDING PRODUCTS
resysta

NOTE

THIS DRAWING AS AN INSTRUMENT OF SERVICE, IS THE PROPERTY OF RESYSTA AND AS SUCH MUST NOT BE REPRODUCED OR COPIED IN PART OR IN WHOLE WITHOUT THE PERMISSION OF THE AUTHOR.

TITLE

ALUMINUM TRIM
VERTICAL SIDING
SUB-DETAIL

SPECIFICATION

TYPICAL DRAWING DETAIL

SHEET CONTENT

ELEVATION
BLOW-UP DETAIL
SECTION
ISOMETRIC VIEW

DRAWING NO.

ATVSD-07

CAD BY:

M.T.C.

CONTINENT

RESYSTA
USA

DATE

03.01.23

CHECKED BY:

C.R.E